

Key:
 Proposed new speed cushion 75mm high.

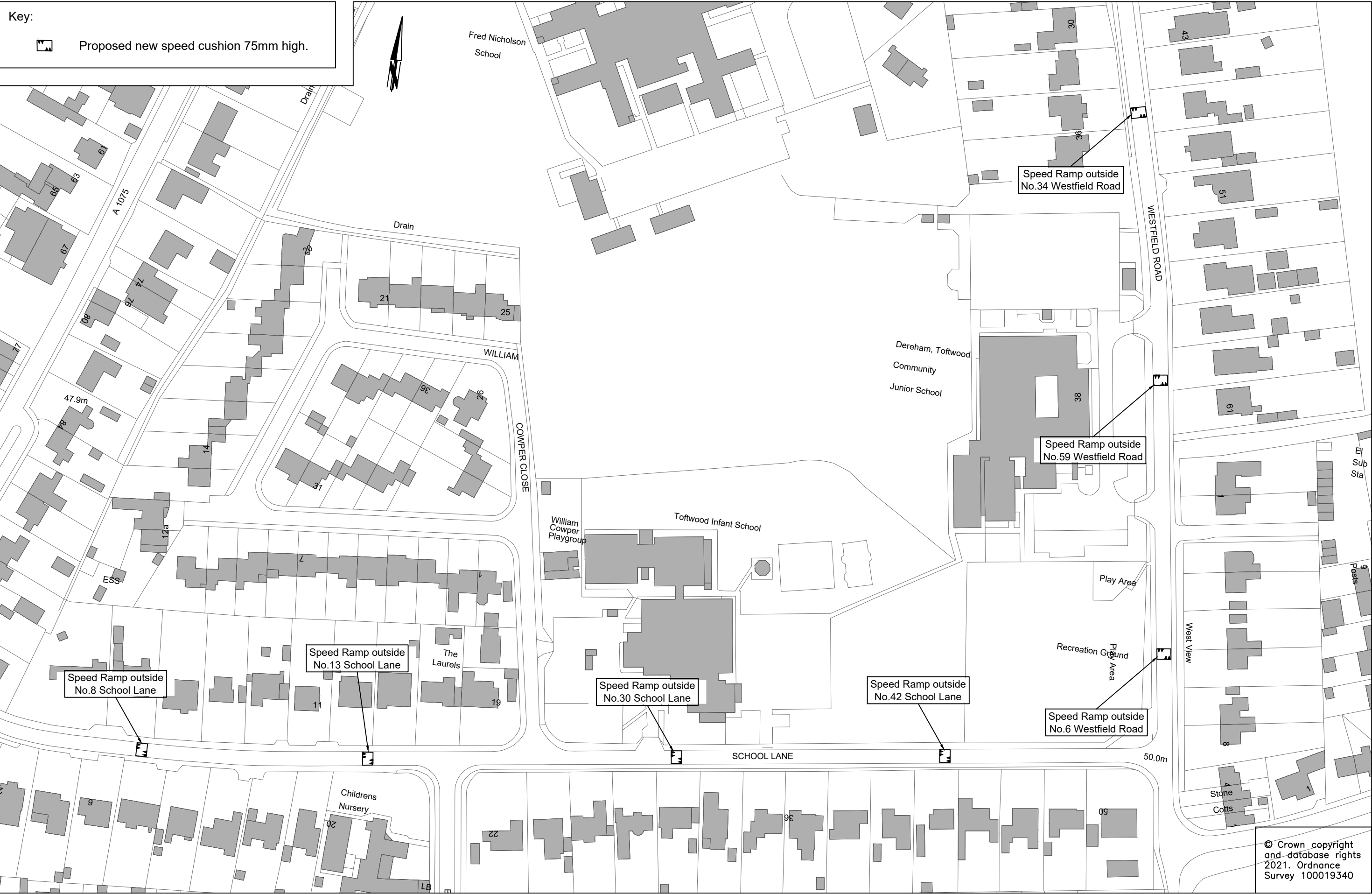

© Crown copyright and database rights 2021. Ordnance Survey 100019340



Tom McCabe
 Executive Director of
 Community and Environmental Services
 Norfolk County Council
 County Hall, Martineau Lane
 Norwich NR1 2SG

DRAWING TITLE
 SPEED RAMP LOCATION PLAN

| REV. | DESCRIPTION | DRAWN BY | CHECKED | DATE |
|------|-------------|----------|---------|------|
| | | | | |
| | | | | |
| | | | | |

| INITIALS | DATE | DRAWING No. |
|------------------|-------|--|
| SURVEYED BY OS | 07/21 | PROJECT TITLE PR3977-HD1-100-002 Section 278 TRO |
| DESIGNED BY MH | 11/22 | |
| DRAWN BY MH | 11/22 | |
| CHECKED BY | | |
| SCALE 1:1250 @A3 | | FILE No. PR3977 |