

SAFETY, HEALTH AND ENVIRONMENTAL INFORMATION

SIGNIFICANT OR EXCEPTIONAL RISKS ARE IDENTIFIED BELOW

CONSTRUCTION

1. PRESENCE OF LOW PRESSURE MAINS (CADENT GAS)
2. PRESENCE OF POTABLE WATER (ANGLIAN WATER)
3. PRESENCE OF LOW VOLTAGE UK POWER NETWORK (UKPN).
4. PRESENCE OF UNDERGROUND TELECOMMUNICATIONS (BT).
5. PRESENCE OF CITY FIBRE.
6. PRESENCE OF SURFACE SEWER (ACTIVE/DECOMMISSIONED).

TRIAL HOLES SHALL BE TAKEN TO LOCATE AND ESTABLISH THE DEPTHS OF EXISTING SERVICES.

MAINTENANCE / CLEANING

- AS ABOVE

DECOMMISSIONING / DEMOLITION

- AS ABOVE

It is assumed that all works will be carried out by a competent contractor working, where appropriate, to an approved method statement

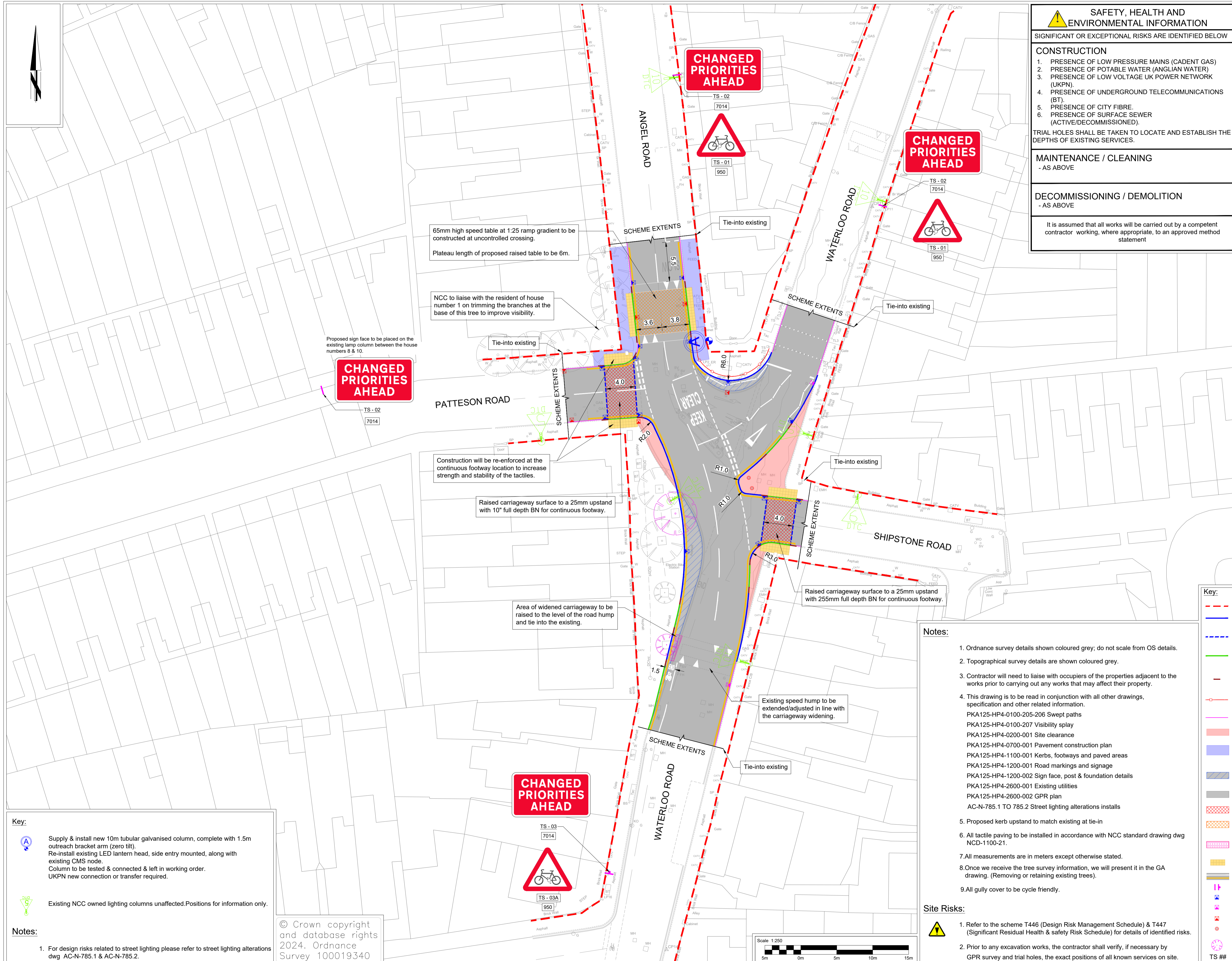
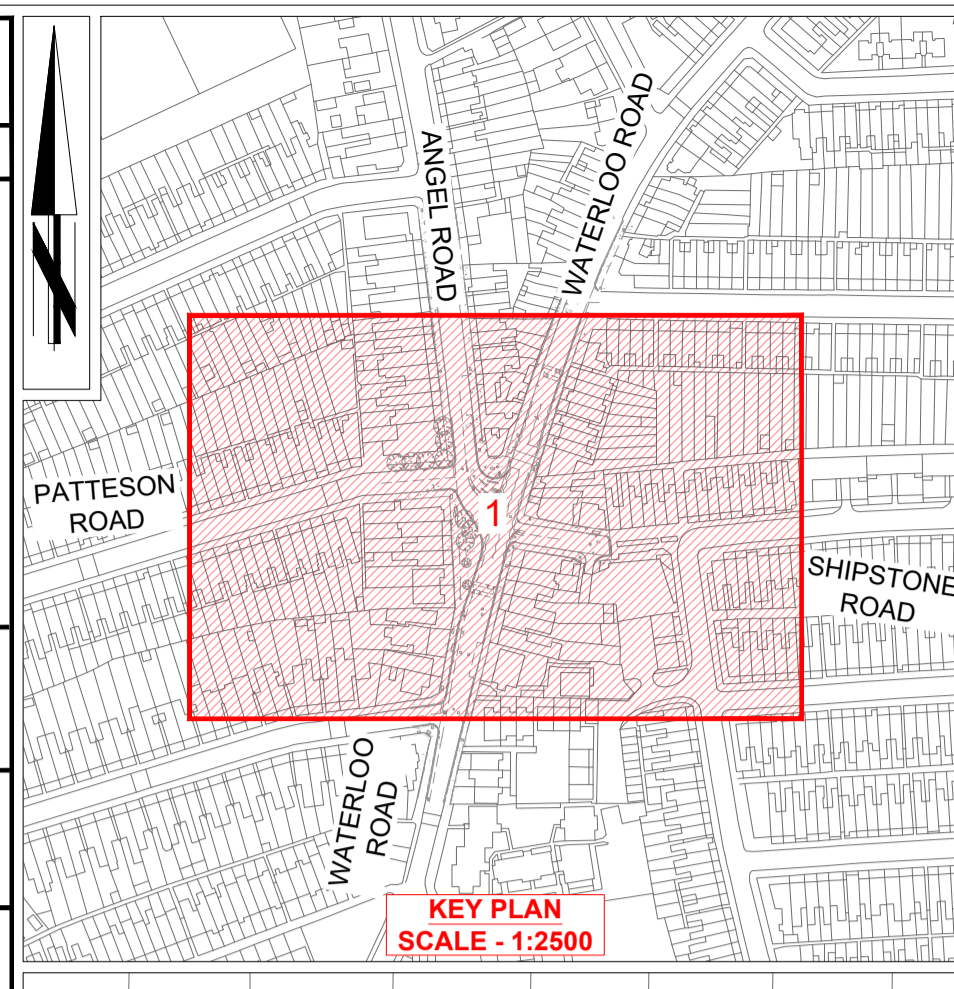

Key:

- Supply & install new 10m tubular galvanised column, complete with 1.5m outreach bracket arm (zero tilt). Re-install existing LED lantern head, side entry mounted, along with existing CMS node. Column to be tested & connected & left in working order. UKPN new connection or transfer required.
- Existing NCC owned lighting columns unaffected. Positions for information only.

Notes:

1. For design risks related to street lighting please refer to street lighting alterations dwg AC-N-785.1 & AC-N-785.2.

© Crown copyright and database rights 2024. Ordnance Survey 100019340

Notes:

1. Ordnance survey details shown coloured grey; do not scale from OS details.
2. Topographical survey details are shown coloured grey.
3. Contractor will need to liaise with occupiers of the properties adjacent to the works prior to carrying out any works that may affect their property.
4. This drawing is to be read in conjunction with all other drawings, specification and other related information.
 PKA125-HP4-0100-205-206 Swept paths
 PKA125-HP4-0100-207 Visibility splay
 PKA125-HP4-0200-001 Site clearance
 PKA125-HP4-0700-001 Pavement construction plan
 PKA125-HP4-1100-001 Kerbs, footways and paved areas
 PKA125-HP4-1200-001 Road markings and signage
 PKA125-HP4-1200-002 Sign face, post & foundation details
 PKA125-HP4-2600-001 Existing utilities
 PKA125-HP4-2600-002 GPR plan
 AC-N-785.1 TO 785.2 Street lighting alterations installs
5. Proposed kerb upstand to match existing at tie-in
6. All tactile paving to be installed in accordance with NCC standard drawing dwg NCD-1100-21.
7. All measurements are in meters except otherwise stated.
8. Once we receive the tree survey information, we will present it in the GA drawing. (Removing or retaining existing trees).
9. All gully cover to be cycle friendly.

Site Risks:

- 1. Refer to the scheme T446 (Design Risk Management Schedule) & T447 (Significant Residual Health & safety Risk Schedule) for details of identified risks.
- 2. Prior to any excavation works, the contractor shall verify, if necessary by GPR survey and trial holes, the exact positions of all known services on site.

Key:

- Highway boundary.
- New precast concrete HB2 kerb with 125mm upstand. For kerb details please see Appendix 11/1 and NCC standard dwg NCD-1100-02.
- New precast concrete 255mm full depth BN kerb with 25mm upstand. For kerb details please see Appendix 11/1.
- New precast concrete Bullnose kerb with 6mm upstand in pedestrian and cycleway crossings. For kerb details please see Appendix 11/1 and NCC standard dwg NCD-1100-02.
- New precast concrete Transition kerb. For kerb details please see Appendix 11/1 and NCC standard dwg NCD-1100-02.
- Proposed pedestrian guardrail. For guardrail details refer to NCC standard dwg NCD-0400-01.
- Edge of existing carriageway.
- New footway. For construction details see Appendix 11/1 and NCC standard dwg NCD-1100-05.
- Existing footway to be planned to a depth of 20mm and resurfaced, with regulating material as required. For resurfacing details refer to NCC standard dwg NCD-1100-05.
- Proposed new carriageway construction. For details please see Appendix 7/1.
- Existing carriageway to be planned and resurfaced, with regulating material as required. For details please see Appendix 7/1.
- Proposed raised carriageway surface of 25mm height for continues footway.
- Proposed raised table to be 65mm in height. For raised table details refer to NCC standard dwg NCD-1100-16.
- Existing speed hump to be extended/adjusted in line with the carriageway widening.
- New buff coloured tactile paving. For tactile details refer to NCC standard dwg NCD-1100-21.
- Proposed road markings.
- Proposed road signs and pole.
- Proposed gully.
- Existing gully to be retained.
- Existing gully to be removed.
- Proposed timber bollard. For bollard details refer to NCC standard dwg NCD-1200-19.
- Existing trees to be removed.
- Proposed traffic sign.

Tom McCabe
Executive Director of
Community and Environmental Services
Norfolk County Council
County Hall, Martineau Lane
Norwich NR1 2SG

DRAWING TITLE
PKA125-Waterloo Rd and Angel Rd Junction
General Arrangement
Detailed Design

REV.	DESCRIPTION	CHECKED	DATE
P01	FIRST ISSUE	EM	13-06-24

DESIGNED BY	INITIALS	DATE	DRAWING No.
PKN	PKN	13-06-2024	PKA125-HP4-0100-001
DRAWN BY	INITIALS	DATE	PROJECT TITLE
IK	IK	13-06-2024	PKA125-Waterloo Rd and Angel Rd Junction
CHECKED BY	INITIALS	DATE	SCALE
EM	EM	13-06-2024	1:250 @ A1
APPROVED BY	INITIALS	DATE	FILE No.
AA	AA	13-06-2024	PKA125