

Bus Stop Clearway on B198-22 for 38 metres in layby,
 153m east of the centre line of 21106-18
 Burrett Road junction, and
 53 m west of the centre line of 21514-12
 Lynn Road junction,

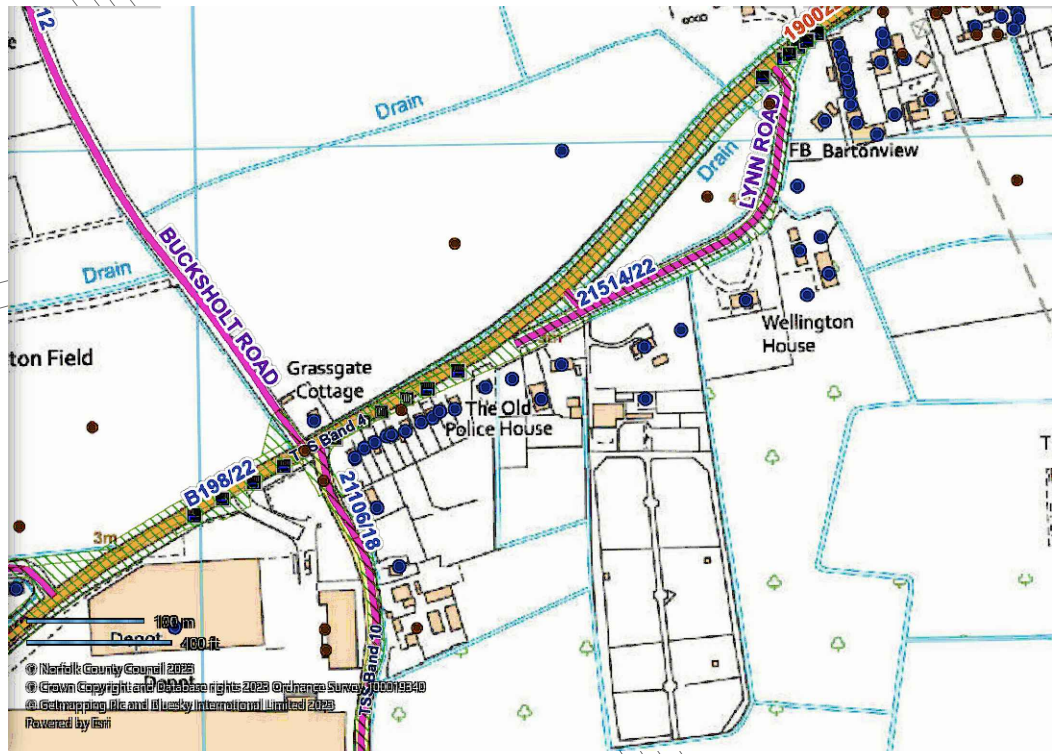

WALSOKEN
 PE14 7AP

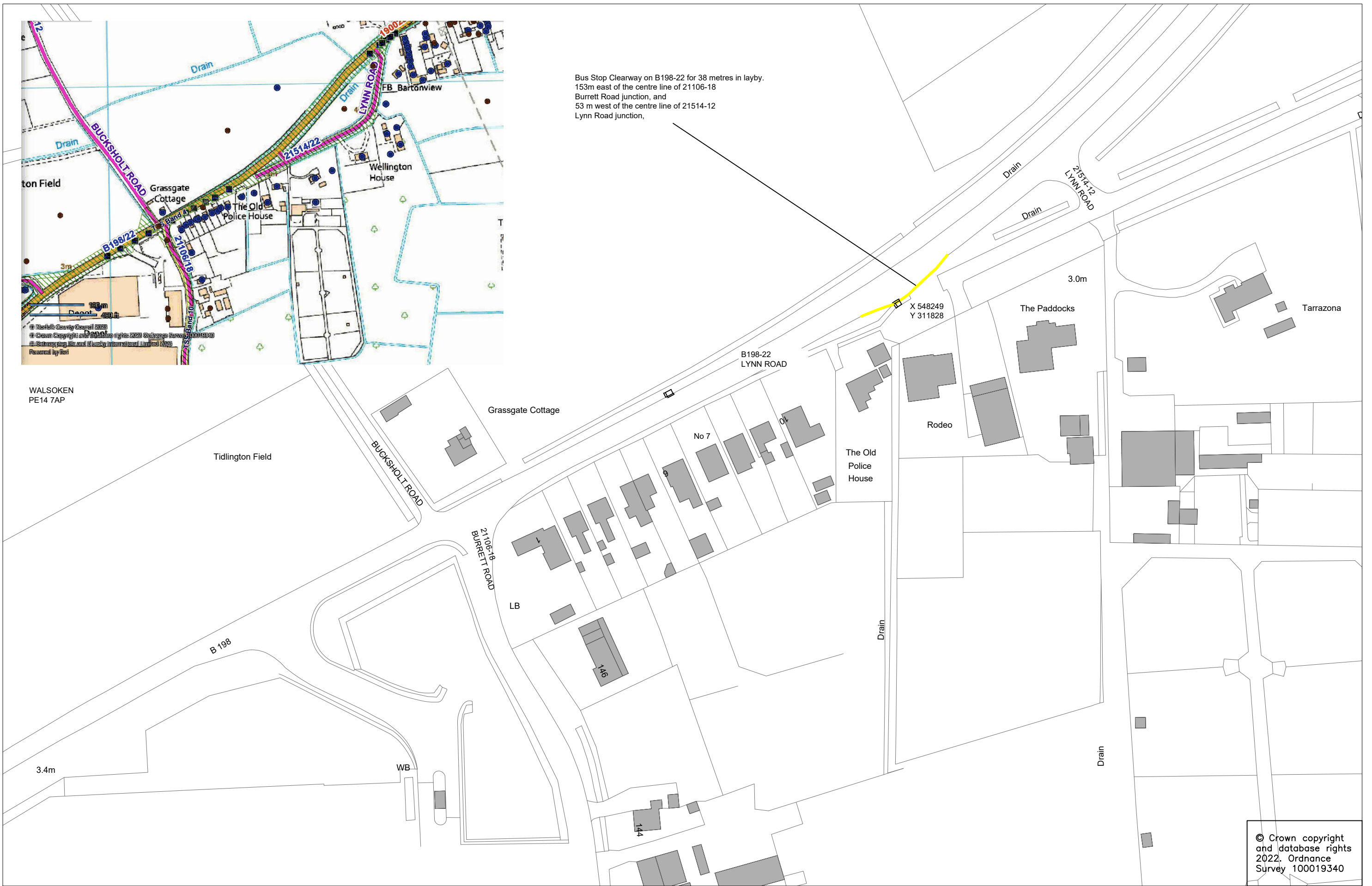

© Crown copyright
 and database rights
 2022. Ordnance
 Survey 100019340

REV.	DESCRIPTION	DRAWN BY	CHECKED	DATE
	TRO Bus Stop Clearway		ALX	3/23

SURVEYED BY	INITIALS	DATE	DRAWING No.
			W7/001
DESIGNED BY			PROJECT TITLE
			PBA 031
DRAWN BY			SCALE
			1: @A3
CHECKED BY			FILE No.