



## **Consultation on a proposal to establish a 16 place Specialist Hub of Inclusion Practice (SHIP), at Roydon Primary School, Diss from 1<sup>st</sup> September 2025.**

### **Our proposal**

Norfolk County Council would like to hear your views on our proposal for Roydon Primary School, Manor Road, Roydon, Diss, Norfolk IP22 5QU, to **establish** a 16 place Specialist Hub of Inclusion Practice (SHIP) from 1 September 2025.

We appreciate that children and young people with complex needs can struggle to engage with learning and cope in a classroom without additional strategies and interventions. A Base can support children to overcome their barriers to learning, to be better able to cope and to be re-integrated into a mainstream setting, in which they can achieve their potential.

The Base will be managed by the Headteacher and governing body at Roydon Primary School. It will offer 8 places for Key Stage 1 and 8 places for Key Stage 2.

This has been identified in Norfolk's Local First Inclusion Programme as a priority for development. The places will be allocated through Norfolk County Admissions processes will grow up to full capacity through this admissions process.

### **What are the benefits of this proposal?**

The main driver for Norfolk County Council and the governors at Roydon Primary School, is to meet the increased demand for specialist educational provision within our area, to best meet the needs of our most vulnerable learners. We feel our proposal would benefit children and young people because it will:

- support more students with special education needs and disabilities to be educated and thrive in their local school and community;
- enhance students' progress by effectively meeting their individual complex needs;
- help facilitate better access to the curriculum and support students to achieve their potential;
- ensure that needs can be met locally avoiding the need for students to spend unnecessary time travelling to an appropriate school further away. This is better for young people and saves the taxpayer money in transport costs;
- increase the availability of places to meet the needs of students with SEND;
- address identified geographical, and age and phase gaps in SRB provision as identified in Norfolk's SEND Strategy;
- support the sharing of complex need expertise and good practice as part of our school.

There are several considerations that Norfolk County Council takes into account when considering changes to organisations of schools. These include school

leadership, performance, impact on the community, diversity of provision, need for places, travel, early years provision and special education provision. The overall driving force is to ensure any change is in the best interest of children's education and achievement.

### Where will the base be located?

This base will be located in the old part of the school building, see diagram below, and will include a small extension, as well as remodelling and refurbishing existing spaces to provide two classrooms, flexible spaces and access to toilets along with its own dedicated entrance and secure external play areas.

#### 6.0 Options Appraisal - Proposed Floor Plan

#### Roydon Primary School

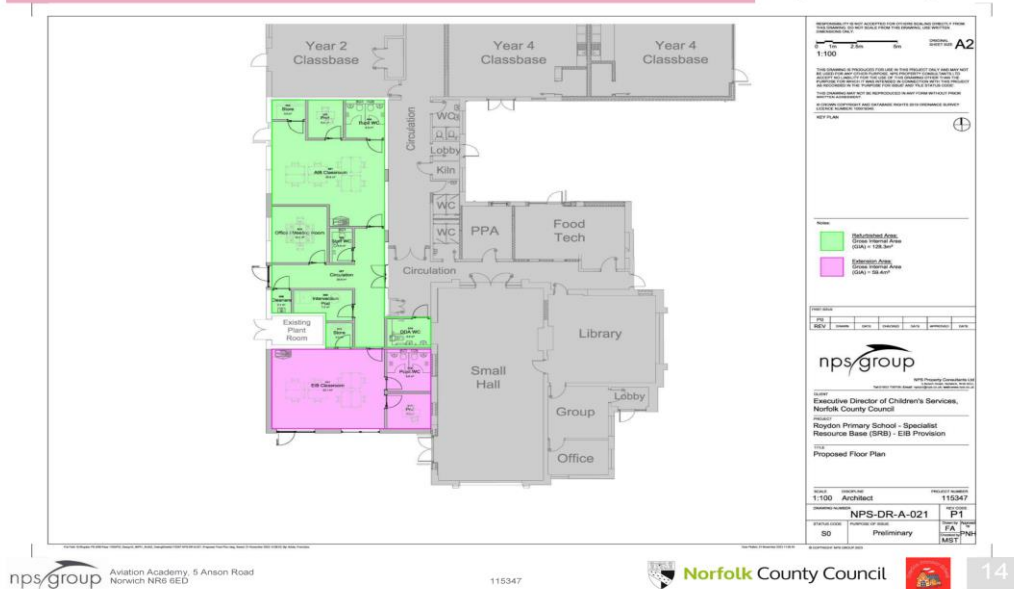

### Capital costs

All capital costs for the capital programme will be funded from Norfolk County Council's Local First Inclusion Programme, to ensure there is an enabling environment.

### How can you have your say?

We will be holding a drop-in event where you can come and find out more about this proposal:

- Wednesday 17 January 2024, 2.15 – 3.15pm at Roydon Primary School

If you are unable to attend these events but would like to comment on our reorganisation proposals please:

- access our online survey: <https://norfolk.citizenspace.com/childrens-services/roydon>
- complete the attached form and hand it to the school office
- or email [schoolreview@norfolk.gov.uk](mailto:schoolreview@norfolk.gov.uk)

**We need all responses by 12 noon, 16 February 2024.**

### What happens next

The Local Authority as the Decision-Maker, will review all the comments made during this consultation and decide whether to proceed to the statutory public notice stage for this proposal.



## Consultation on proposed changes to Roydon Primary School, Diss

Let us know what you think of our proposal

How far do you agree or disagree with our proposal to establish a 16 place Specialist Hub of Inclusion Practice, from 1 September 2025? Please tick a box.

Strongly agree

Agree

Neither agree or disagree

Disagree

Strongly disagree

Why do you say this? Please write in the box below.

Are there any other comments or suggestions you would like to make to help us with this decision and in planning for the future provision of the children? Please write in the box below.

We would like to hear from many different people as your views help us to decide whether or not we make these changes. We will also use any personal information to understand how different groups of people feel about our proposal to establish a 16 place Specialist Hub of Inclusion Practice at Roydon Primary School.

We will process any personal information we receive from you in line with the General Data Protection Regulation (GDPR) (Regulation (EU) 2016/679), the Data Protection Act 2018 and Norfolk County Council's data protection policy and guidelines. This means that Norfolk County Council will hold your personal data and only use it for the purpose for which it was collected, being this consultation.

We won't identify individuals when reporting back our findings and under our record management policy we will keep this information for five years. We will also, under normal circumstances, not pass your personal data on to anyone else. However, we may be asked under access to information laws to publish or disclose some, or all, of the information you provide in response to this consultation, including any personal information. We will only do this where such disclosure will comply with such relevant information laws which include the Freedom of Information Act 2000, the Data Protection Act 2018 and the Environmental Information Regulations 2004.

Please tell us who you are, (tick all that apply):

- |   |  |
|---|--|
| <input type="checkbox"/> Pupil                                    | <input type="checkbox"/> School governor       |
| <input type="checkbox"/> Parent / Guardian                        | <input type="checkbox"/> Local resident        |
| <input type="checkbox"/> Member of the Parent Teacher Association | <input type="checkbox"/> Local business        |
| <input type="checkbox"/> Member of staff                          | <input type="checkbox"/> Local sports group    |
|   | <input type="checkbox"/> Local community group |

Other (please specify): \_\_\_\_\_

At which school? \_\_\_\_\_

What is your postcode? \_\_\_\_\_

Your views will help us decide if this proposal goes ahead. You can tell us your views by returning this completed form to:

- Accessing our online survey: <https://norfolk.citizenspace.com/childrens-services/roydon>
- Your school office
- Emailing [schoolreview@norfolk.gov.uk](mailto:schoolreview@norfolk.gov.uk)

**This consultation ends at 12 noon, 16 February 2024**